

Customer Display

**Vacant Land**  
890775 Active

**Near Deer Lake Rd**  
Exeland, WI 54835

**L\$864,000**

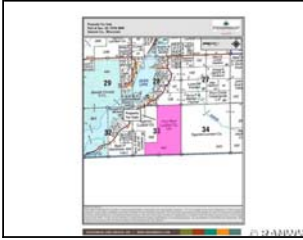

<b>Type:</b>	Acreage-6 or More	<b>County:</b>	Sawyer
<b>Twp:</b>	Meteor	<b>Area:</b>	47 - Birchwood Schl Dist
<b>Sec/Twp/Rng:</b>	S33/T37N/R8W	<b>School Dist:</b>	Birchwood
<b>Lot Size:</b>		<b>Taxes:</b>	\$284.40
<b>Acreage:</b>	360.00	<b>Tax Year:</b>	2013
<b>Waterfront:</b>	No	<b>Tax ID:</b>	20117, 40002, 40003, 20119, 20125, 20126
<b>Terrain:</b>	Wooded		
<b>Utilities:</b>	None		

**Use Value Assmt:**  
Area 2:

**Road Access:**  
Common:

**Plat:**  
Restrictive Cov:

**Non Conform:**

**Wtr Frnt Type:**  
**Lake/River Name:**  
**Lake Size:**  
**Waterfront CF:**

**Wtr Frnt Ft:**  
**Own Frntg:**  
**Deeded Access:**

**Seasons:**  
**Easement:**  
**Lake Depth:**

**Fencing:**  
**Showing:** Other-See Agent Remarks  
**Soil Type:**  
**Zoning:** Forestry

**Occupancy:**  
**Sewer:**  
**Water:** None

**Directions:** From Exeland travel west on County Highway C for 4.5 miles, stay straight on Deer Lake Rd for approximately 2.5 miles to the easement access road on the left.

**Remarks:** This 360-acre tract is a great timberland investment. The forest cover is dominated by northern hardwoods. Enrolled in the Managed Forest Law program.

**Legal:** NENE, NWNE, SWNE, SENE, SESW, NESE, NWSE, SWSE, SESE

**Condition Report:** Yes

**Seller Financing:**

**Seller Fin Remarks:**



**Prepared by:** Todd Frederickson  
Steigerwaldt Land Sales Company LLC  
856 N 4TH ST  
Tomahawk, WI 54487

**Email:** [todd.frederickson@steigerwaldt.com](mailto:todd.frederickson@steigerwaldt.com)  
**Off. Ph#:** 715-453-3274  
**Preferred Ph#:** 715-612-0508  
**Certs:**

Not guaranteed. Information provided by NW WI MLS is compiled from 3rd party source.  
Neither NW WI MLS, the listing broker or its agents or subagents are responsible for its accuracy.  
PRESENTING AGENT MAY NOT NECESSARILY BE THE LISTER.06/24/2015 4:54 PM